

# Manual Chain Hoists

Black & Galvanized Load Chain

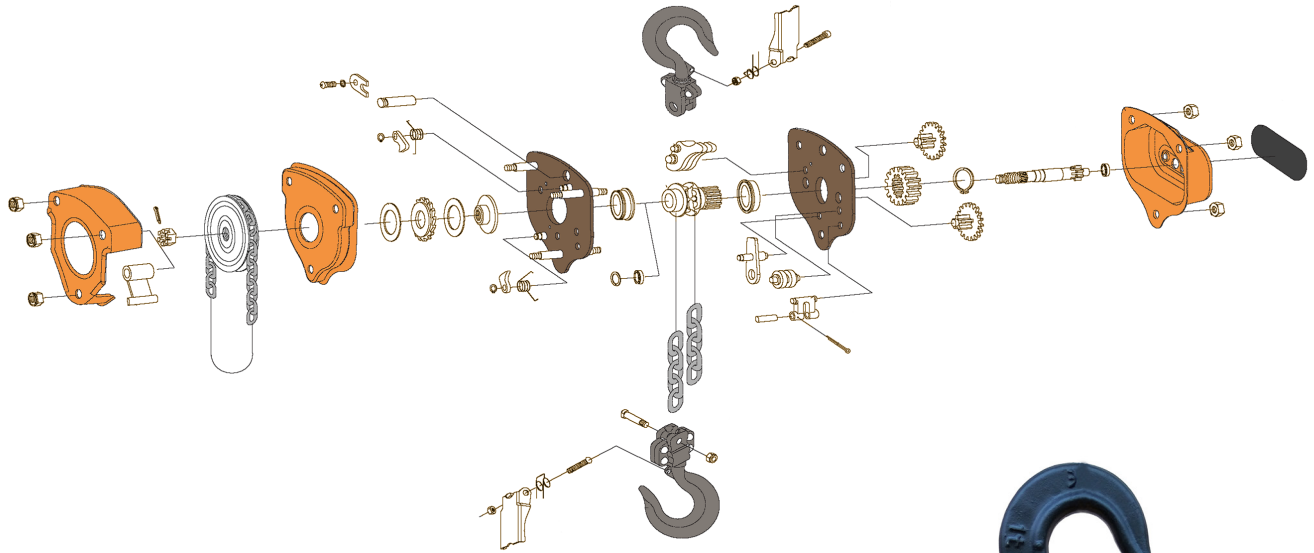

- ASME B30.16 Compliant
- Double Pawl Ratchet Brake
- 360° Swivel Top & Bottom Hook
- Notched Hooks
- Forged Safety Latches
- Grade 80 High Tensile Chain
- Zinc Plated Load Chain
- From ½ Ton Up to 10 Ton
- Available in 10' or 20' Lengths
- Custom Chain Lengths Available



# Manual Chain Hoists

## Black & Galvanized Load Chain

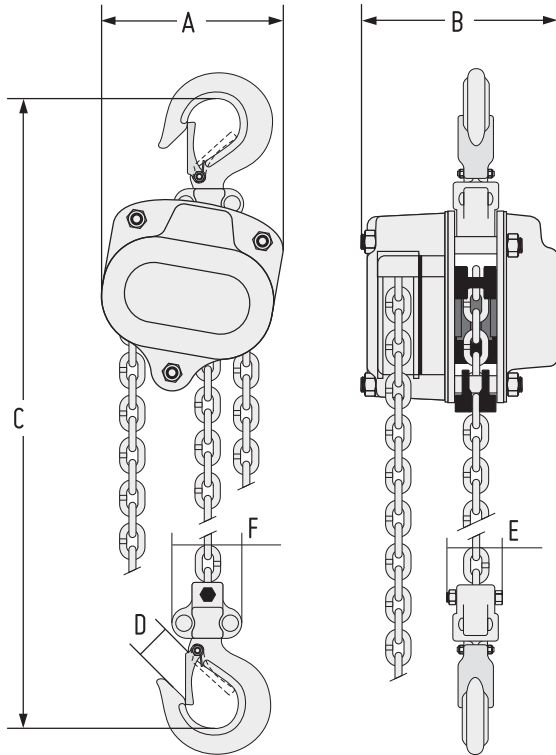

Product Code	Capacity	Standard Lift	Load Chain Ø x Chain Fall Lines	Net Weight
	tons	feet	mm	lbs
CH05-10	1/2	10	Ø 5 x 1	17
CH05-20	1/2	20	Ø 5 x 1	27
CH10-10	1	10	Ø 6 x 1	25
CH10-20	1	20	Ø 6 x 1	37
CH20-10	2	10	Ø 8 x 1	40
CH20-20	2	20	Ø 8 x 1	55
CH30-10	3	10	Ø 7.1 x 2	49
CH30-20	3	20	Ø 7.1 x 2	76
CH50-10	5	10	Ø 10 x 2	88
CH50-20	5	20	Ø 10 x 2	119
CH100-10	10	10	Ø 10 x 4	154
CH100-20	10	20	Ø 10 x 4	219



Product Code	Capacity	A	B	Headroom (C)	D	E	F
	tons	inches	inches	inches	inches	inches	inches
CH05-10	1/2	5.98	5.20	12.40	1.06	0.47	1.97
CH05-20	1/2	5.98	5.20	12.40	1.06	0.47	1.97
CH10-10	1	6.18	5.98	13.98	1.06	1.06	2.17
CH10-20	1	6.18	5.98	13.98	1.06	1.06	2.17
CH20-10	2	6.69	5.98	15.94	1.42	1.38	2.36
CH20-20	2	6.69	5.98	15.94	1.42	1.38	2.36
CH30-10	3	8.15	5.98	19.69	1.50	2.17	3.86
CH30-20	3	8.15	5.98	19.69	1.50	2.17	3.86
CH50-10	5	10.51	7.44	26.77	1.89	3.07	5.04
CH50-20	5	10.51	7.44	26.77	1.89	3.07	5.04
CH100-10	10	11.02	7.44	29.53	2.13	3.54	9.25
CH100-20	10	11.02	7.44	29.53	2.13	3.54	9.25